

PLAN LAYOUT

SCALE: 1:200

LEGEND - SERVICES

PROPOSED	EXISTING	DESCRIPTION
		STORMWATER MANHOLE/PIPE
		SEWER MANHOLE/PIPE
		EFFLUENT MANHOLE/PIPE
		RAIL LINE
		COMMUNICATION MANHOLE/DUCTS
		ELECTRICAL MANHOLE/DUCTS
		WATERMAIN
		FENCE
		CATCHMENTS BOUNDARY
		EXISTING OIL LINE
		NEW STORMWATER IN ADJACENT PROJECT AREAS
		RELOCATED SERVICE
		DEMOLISH EXISTING SERVICE
		ASPHALT ROAD
		EARTH BANKS
		NEW BLOCK PAVEMENT

R-01
3.42

B2

ABBREVIATIONS

MT	= MANHOLE	EX	= EXISTING	FH	= FIRE HYDRANT
ELP	= ELECTRICAL LIGHT POLE	BM	= BENCH MARKS	V	= WATERMAIN VALVE
HML	= HIGH MAST LIGHT	SW	= STORMWATER		
		EF	= EFFLUENT		

SETTING OUT COORDINATE:

- R - RAIL EMBANKMENT
- M - MULTIPURPOSE TERMINAL
- S - STOCKPILE
- C - CAUSEWAY
- T - TIPPLER

BENCHMARK

GENERAL NOTES:

- THE CONTRACTOR WILL BE DEEMED TO HAVE INSPECTED THE SITE AND BE IN AGREEMENT WITH THE WORKS REQUIRED AS PER THE TENDER DOCUMENTS. UNLESS ALTERNATIVE PROPOSALS WITH COST IMPLICATIONS ARE RECEIVED TOGETHER WITH THE TENDER DOCUMENTS. ALTERNATIVE PROPOSALS SUBMITTED DURING CONSTRUCTION SHALL BE ON A DESIGN AND CONSTRUCT BASIS, WITH THE DESIGN AT CONTRACTOR'S EXPENSE.
- VARIATIONS DEEMED NECESSARY BY THE CONTRACTOR SHALL BE FORWARDED TO THE PROJECT MANAGER IN WRITING FOR APPROVAL BEFORE ANY CONSTRUCTION BASED ON THE VARIATION COMMENCES.
- SERVICES SHOWN ON DRAWING ARE KNOWN OR SOURCED FROM EXISTING DRAWINGS. THE CONTRACTOR MUST ENSURE THAT ALL SERVICES THAT INTERSECT OR RUN ALONGSIDE THE PROPOSED WORKS ARE LOCATED BEFORE CONSTRUCTION COMMENCES. ANY CLASHES SHALL BE REPORTED TO THE PROJECT MANAGER IN WRITING. THE CONTRACTOR SHALL BE HELD LIABLE FOR ANY DAMAGES TO EXISTING SERVICES DUE TO NEGLIGENCE.
- ALL EXISTING PIPES AND MANHOLES INCORPORATED INTO THE NEW SYSTEM SHALL HAVE DEFECTS RECTIFIED TO COMPLY TO STANDARDS FOR NEW WORKS.
- DIMENSIONS SHOWN ON DRAWINGS SHALL TAKE PREFERENCE OVER DIMENSIONS SCALED.
- ALL LEVELS AND DIMENSIONS SHALL BE CHECKED BEFORE ANY WORK COMMENCES. FAILURE TO DO SO SHALL DEEM THE CONTRACTOR LIABLE FOR ANY WORK REQUIRED TO RECTIFY ERRORS AS A RESULT OF THE FAILURE TO CHECK THE LEVELS AND DIMENSIONS.
- DIMENSIONS ARE IN MILLIMETERS AND LEVELS ARE IN METERS, UNLESS OTHERWISE INDICATED.
- THE LATEST REVISION OF SANS SPECIFICATIONS SHALL APPLY. ALL WORK SHALL BE DONE IN ACCORDANCE WITH RELEVANT SANS SPECIFICATIONS, UNLESS OTHERWISE INDICATED.
- ALL LENGTHS SHOWN ARE APPROXIMATE AND SHALL BE CONFIRMED ON SITE BY CONTRACTOR.
- FOR SETTING OUT COORDINATES. PLEASE SEE SHEET 2

EARTHWORKS

- ANY DISCREPANCIES IN LEVELS AND SETTING OUT DATA TO BE QUERIED WITH THE ENGINEER PRIOR TO COMMENCEMENT OF ANY WORK.
- ALL WORKMANSHIP TO BE IN ACCORDANCE WITH SANS 1200 PART D: EARTHWORKS AND THE RELEVANT PROJECT SPECIFICATIONS AS INCLUDED IN THE CONTRACT.
- BEFORE PLACING ANY FILL MATERIAL, THE EXISTING GROUND SURFACE MUST BE CLEARED AND GRUBBED OF ALL VEGETATION AND ORGANIC MATTER.
- UNLESS OTHERWISE INDICATED, ALL BANK BATTERS TO BE: 1:1.5 OUT AND 1:2 FILL.
- THE UNCOMPLICATED THICKNESS OF FILL LAYERS SHALL NOT EXCEED 300mm.
- LOCATE ALL EXISTING SERVICES IN AREA PRIOR TO ANY CONSTRUCTION TAKING PLACE.

STORMWATER NOTES

- TRENCHES FOR PIPES TO BE EXCAVATED AND BACKFILLED IN ACCORDANCE WITH THE REQUIREMENT OF SANS 1200 DB - PIPE TRENCHES.
- ALL RIGID CONCRETE PIPES SHALL HAVE CLASS B BEDDING UNLESS STATED OTHERWISE.
- FOR STORMWATER PIPES SHALL BE SPIGOT & SOCKET CLASS 1000 (SANS 677).
- ALL CONCRETE PIPE JOINTS TO BE WRAPPED WITH 'A2 BIDIM' (NONWOVEN, CONTINUOUS FILAMENT NEEDLE PUNCHED, POLYESTER, GEOTEXTILE) MIN. WIDTH TO BE 750mm FOR PIPES 3000 TO 6000.
- NB: ALL MANHOLE COVERS TO SUIT CRUSHPALL OF FINISHED PAVING.
- ON COMPLETION, THE INSTALLATION SHALL BE TESTED TO THE ENGINEER'S SPECIFICATION.
- THE CONTRACTOR SHALL SUBMIT A FULL SET OF AS-BUILT DRAWINGS UPON COMPLETION OF THE INSTALLATION.
- ALL EXISTING STORMWATER PIPES, MANHOLES, CHANNELS AND ANY OTHER STORMWATER INFRASTRUCTURE TO BE CLEARED AND CLEARED OF ALL DEBRIS BEFORE ANY WORK COMMENCES. ALL DAMAGED EXISTING STORMWATER INFRASTRUCTURE SHALL BE REINSTATED TO ORIGINAL CONDITION.
- ANY DISCREPANCIES IN LEVELS AND SETTING OUT DATA TO BE QUERIED WITH THE ENGINEER PRIOR TO COMMENCEMENT OF ANY WORK.
- ALL EXISTING STORMWATER PIPES ARE CONCRETE UNLESS STATED OTHERWISE.
- WHERE MINIMUM COVER OF 1000mm FOR OPERATIONAL AREAS & 600mm FOR NON OPERATIONAL AREA CANNOT BE ACHIEVED, CONCRETE ENCASEMENT IS REQUIRED AS PER THE DETAIL DRAWINGS.
- FOR ANY FURTHER DETAIL AND INFORMATION FOR NEW AND EXISTING STORMWATER NETWORKS, PLEASE SEE LONG SECTION DRAWINGS SHEET 1 TO 3.
- ALL EXISTING STORMWATER PIPES AND MANHOLES TO BE DEMOLISHED AND REMOVED WHERE AN UPGRADED NETWORK IS TO BE CONSTRUCTED.

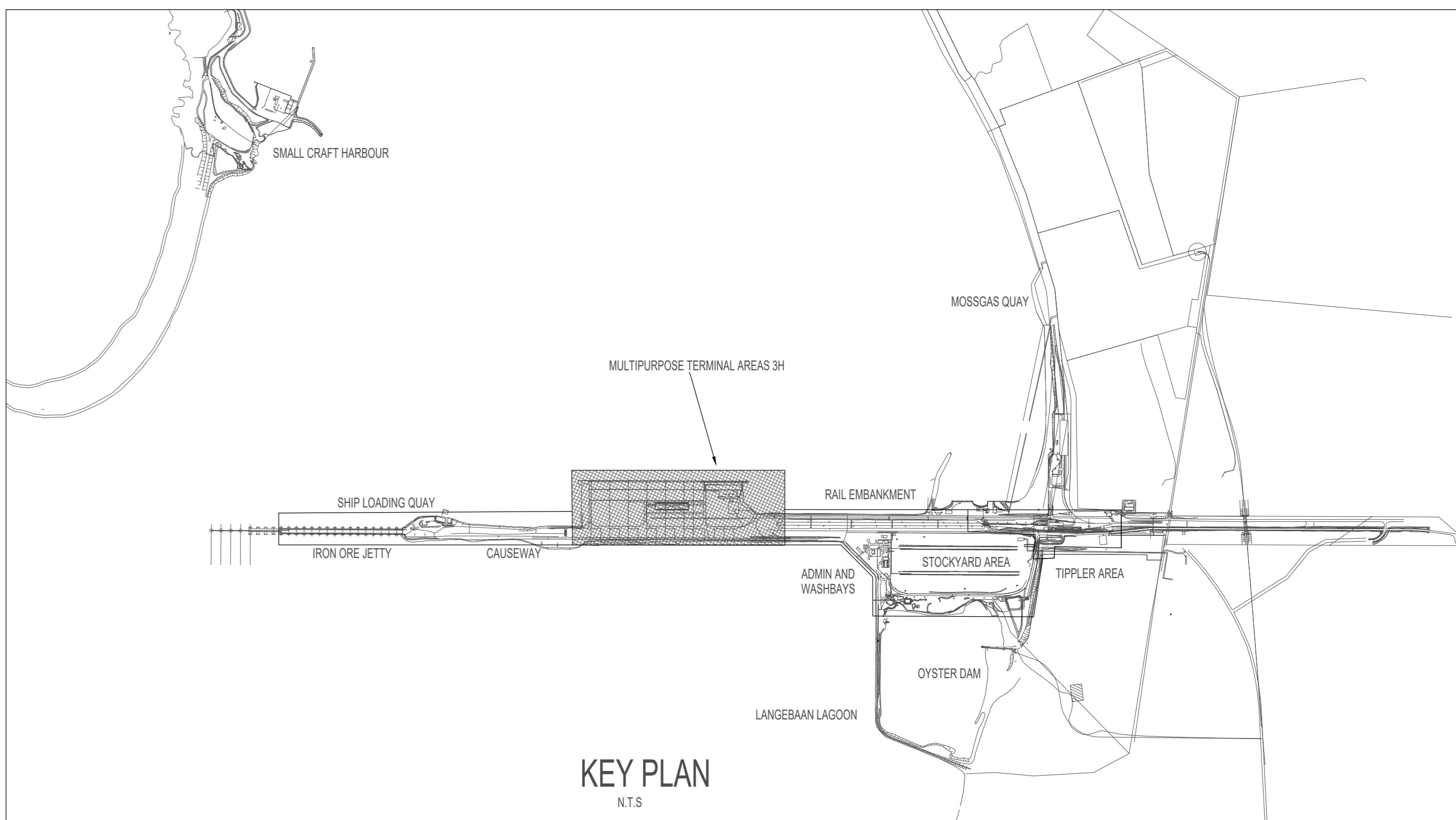

KEY PLAN

N.T.S

DRAWING NO.	DESCRIPTION
5200157-2-001-C-LA-0004-01	MULTIPURPOSE TERMINAL STORMWATER LAYOUT & KEY PLAN
5200157-2-001-C-LA-0004-02	MULTIPURPOSE TERMINAL DETAILED LAYOUT
5200157-2-001-C-SE-0004-01	MULTIPURPOSE TERMINAL STORMWATER LONG SECTIONS SHEET 1 OF 3
5200157-2-001-C-SE-0004-02	MULTIPURPOSE TERMINAL STORMWATER LONG SECTIONS SHEET 2 OF 3
5200157-2-001-C-SE-0004-03	MULTIPURPOSE TERMINAL STORMWATER LONG SECTIONS SHEET 3 OF 3
5200157-2-001-C-LA-0004-03	MULTIPURPOSE TERMINAL DEMOLITION LAYOUT
5200157-2-001-C-DE-0004-01	TYPICAL STORMWATER MANHOLE DETAILS
5200157-2-001-C-DE-0001-02	TYPICAL STORMWATER MANHOLE DETAILS
5200157-2-001-C-DE-0001-03	TYPICAL STORMWATER GRID INLET & CATCHPIE DETAILS
5200157-2-001-C-DE-0001-04	TYPICAL HEADWALL, SCOUR & CONCRETE ENCASEMENT DETAILS
DRAWING NO.	REFERENCE
REFERENCE DRAWINGS	

NOTES:

- MEASUREMENTS ARE BASED ON METRIC SYSTEM.
- ALL LEVELS ARE IN METERS TO MEAN SEA LEVELS (MSL).
- DO NOT SCALE DRAWING - ONLY DIMENSIONS SHOWN TO BE USED.
- THE CONTRACTOR SHALL VERIFY ALL SERVICES OR CONDITIONS ON THE SITE AND NOTIFY THE ENGINEERING OF ANY VARIATIONS FROM DIMENSIONS BEFORE CONSTRUCTION.

					CONTRACTOR / CONSULTANT				TRANSPNET PORT TERMINALS			
					TITLE	NAME	SIGN	DATE	TITLE	NAME	SIGN	DATE
					-	-	-	-	DRAWN	HvdW		28 10 22
					-	-	-	-	CHECKED	RM		28 10 22
					-	-	-	-	DESIGNED	HvdW		28 10 22
					-	-	-	-	CHECKED	RM		28 10 22
					-	-	-	-	-	-	-	-
					OPERATING DIVISIONS				Pr. Eng. / Pr. Tech. Eng.			
					TITLE	NAME	SIGN	DATE				
00	ISSUED FOR CONSTRUCTION				HvdW	RM	RN	04/08/2023				
0A	ISSUED FOR CLIENT APPROVAL				HvdW	RM	RN	28/10/2022				
NO.	DESCRIPTION				BY	CHKD	APPD	DATE	NAME	R. NADOO	SIGNATURE	DATE
												04 08 23
									REG. NUMBER	201070206		
									SCALE:	AS SHOWN		
REVISIONS												
This Document including all design and information therein is Confidential Intellectual Property of Transnet. Copyright and all other rights are reserved by Transnet. This Document may only be used for its intended purpose.												

Transnet Port Terminals

TRANSNET

PORT OF SALDANHA

SALDANHA STORMWATER MANAGEMENT
MULTIPURPOSE TERMINAL
DEMOLITION LAYOUT

PROJECT NUMBER	DOB	FRL	DSB	TYPE	DRAWING NO.	SHEET	REV	ID
0A	5	2	0	0	1	5	7	2
	0	1		C	L	A	0	0
	0	4			0	3	0	0
								HD